

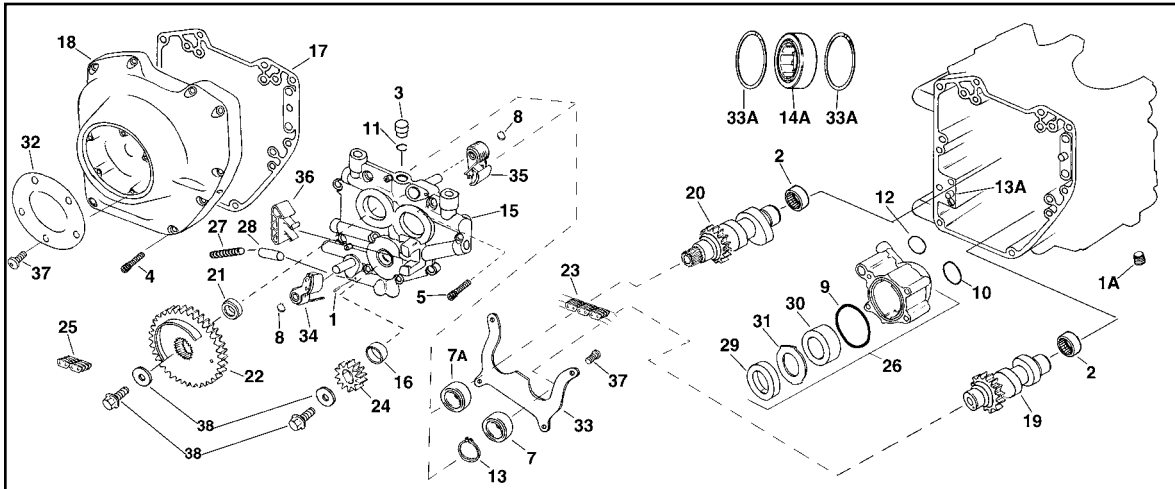

1999-up Cam Shaft Component for TC-88



Cam Shaft Components for TC-88 models, 1999-up unless noted.

VT No.	OEM	#	Item
12-1178	601	1	Roll Pin
12-0750	9198	2	Left Side Cam Shaft Bearing 1999-05 FXD, 1999-06 FXST, FLST, FLT
12-0765	9215	2	As Above 2006-up FXST, FLST, FLT
9946-20	4740A	4	Allen Screw Set, As Above
37-1002	4741A	5	Screw, As Above
12-0751	8990A	7	Ball Bearing 1999-05 FXD, 99-06 FXST, FLST, FLT
12-0762	8983	7A	Bearing 1999-05, As Above
12-0905	11031	8	Retaining Ring 1999-05, As Above
14-0814	11286	9	O-Ring 1999-05, As Above
14-0803	11293	10	O-Ring, As Above
14-0819	11298	11	O-Ring, Viton 1999-05 As Above
12-0753	11494	13	Retaining Ring 1999-05 As Above
12-0761	16589-99	13A	Dowel Ring, 1999-up FXST, FLST, FXD 1999-16 FLT
10-0587	14761-00		Pad Set, TC-88B, 2000-up FXST, FLST
15-1214	17045-99	14	Cam Service Gasket Kit, 1999-up FXST, FLST, FXD, 1999-16 FLT
13-0233	18223-98		Performance Valve Spring Set 1999-04 FXST, FXD
12-0754	24623-99C	14A	Right Side Main Bearing 1999-06 FXST, FLST, FLT, 1999-05 FXD
12-0768	24605-07	14A	As Above 2007-up FXST, FLST, FLT, 2006-up FXD
15-1198	25244-99A	17	Cam Cover Gasket, 1999-up FXST, FLST, FXD, 1999-16 FLT
10-0813	25247-99	18	Chrome Cam Cover, 1999-00 FXST, FLST, FXD, FLT
42-0702	25369-01A		Chrome Cam Cover, 2001-up FXST, FLST FXD, 2001-16 FLT
10-0904	25674-99	21	Cam Drive Spacer, .360 1999-05 FXD, 1999-06 FXST, FLST, FLT
10-0905	25675-99	21	Cam Drive Spacer, .365, As Above

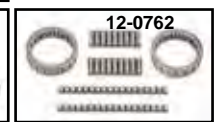

10-0913	25738-06	21	Cam Drive Spacer .150, 2007-up FXST, FLST, 2007-16 FLT, 2006-up FXD
10-0481	25607-99	23	Secondary Cam Drive Chain 99-05
10-0915	25683-06	23	Secondary Cam Drive Chain 2007-up FXST, FLST, 2007-16 FLT, 2006-up FXD
10-0483	25610-99	25	Primary Cam Drive Chain, 1999-05 FXD, 1999-06 FLT, FXST, FLST
10-0917	25675-06	25	As Above 2007-up FXST, FLST, 2006-up FXD, 2002-16 FLT
12-9902	26035-99	26	Oil Pump Assembly Cpt 1999-05 FXD, 1999-06 FXST, FLST, FLT
12-9990	26037-06	26	As Above 2006-up FXD, 2007-up FXST, FLST, 2007-16 FLT
12-1418	26400-82B	28	Oil Pump Relief Valve
42-0119	32679-99	32	Sensor Cover, Chrome
12-0760	35115-99	33A	Retaining Ring 1999-01
10-0485	39954-99	34	Primary Cam Drive Chain Tensioner 1999-06 FXST-FLST, FLT, 1999-05 FXD
10-0918	39968-06	34	As Above 2007-up FXST-FLST, 2006-up FXD, 2007-16 FLT
10-0486	39964-99A	35	2nd Cam Drive Chain Tensioner L1999-06 FXST, FLST, FLT, BT except 2006-05 FXD
10-0919	39969-06	35	As Above 2007-up FXST-FLST, 2007-16 FLT, 2006-up FXD
10-0924		34& 35	Cam Chain Tensioner Set 2007-up FXST, FLST, 2006-up FXD, 2007-16 FLT
10-0487	39965-99	36	Chain Guide 1999-05 FXD, 1999-06 FXST, FLST, FLT
9954-5	68042-99	37	Sensor Cover Screw Set



Crank Sensor fits 1999-up FXST-.FLST, FXD, 1999-16 FLT. **VT No. 32-0988**



Twin Cam Heavy Duty Billet Cam Plate features enlarged oil passages for improved oil flow and hard anodized finish. The billet aluminum and anodized finish increases the strength of plate over stock plate and allows the plate to hold tolerances under high temperatures. Use with gear drive cams.

VT No.	Item
43-1059	1999-06 FXST, FLST, FLT; 1999-05 FXD
43-1060	2007-up FXST, FLST, 2007-16 FLT; 2006-up FXD



Chain Tensioner Spacer Kit.
VT No. 10-7001



V-Twin Inner Cam Bearing Tool safely installs the inner cam bearings to the proper depth in the case without damaging bearings.

VT No. 16-1390



Inner Cam Bearing Remover Tool allows removal of needle bearing and will also keep needles from falling into engine. For use on 2006-up FXD, 2007-up FXST, FLST, 2007-16 FLT.

VT No. 16-1351



Chrome Crank Sensor Cover Includes mount screw. 1999-up FXD-FLT. **VT No. 42-0953**