

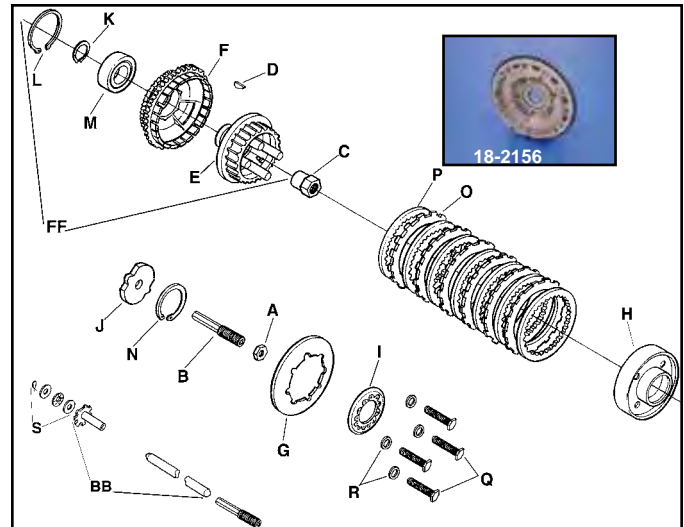

Complete Assembly
1985-90.
VT No.
18-0130

1985-90 Big Twin Clutch Parts



1984-90 Big Twin Clutch Hubs feature the updated factory construction which has a machined steel center with aluminum outer

splined ring, secured by allen screws, with steel studs welded in place. Order related hardware separately.

VT No.	OEM	Year	Type
18-8153	37550-84A	1984-90	V-Twin
18-8170*	37550-84	1984-90	V-Twin

*Note: Early style hub with aluminum studs



1985-90 1340 Big Twin Clutch Pack Hardware.

VT No.	#	OEM	Item
12-0563	A	7848W	Nut, 5 pack
18-3259	B	37357-84	Adjusting Screw for Stock
18-3253	B	37090-84A	Adjusting Screw for 18-3680
17-9246	BB	Kit	Rod Set, 1985-86
17-9248	BB	Kit	Rod Set, 1987-89
17-9249	BB	Kit	Rod Set, 1990
12-0564	C	37496-84	Nut, Mainshaft
12-0212	D	37523-85	Key, 10 pack
18-8153	E	37550-84A	Clutch Hub, V-Twin
18-3641	F&M	37702-84A	84-Early85 Clutch Drum with Ring Gear
18-2156	F&M	37707-84A	Late85-90 Clutch Drum with Ring Gear
18-8290	G	37875-86A	Diaphragm Spring
18-0186	FF	Kit	1984-Early85 Drum/Hub Assembly
18-0187	FF	Kit	Early1985-90 Drum/Hub Assembly
18-3680	H	37901-84A	Pressure Plate
18-3255	I	37902-86B	V-Twin Adjuster Plate
18-3215	J	37903-84	Release Plate
12-0953	K	37904-84	Retaining Ring External
12-0954	L	37905-84	1984-97 Retaining Ring Internal
12-1375	L	37905-84	1984-97 Retaining Ring Internal, 5 pack
12-0308	M	37906-84	Bearing
12-0955	N	37907-84	Retaining Ring, 10 pack
18-1147	O	37931-84	Friction Disc, 6 pack
18-1148	P	37975-84	Drive Disc, 7 pack
37-8944	Q	2881W	Bolt and Washer
37-9272	R	6242W	Washer
18-3623	S	Kit	Bearing Kit
12-0923	T	11096	Retaining Ring

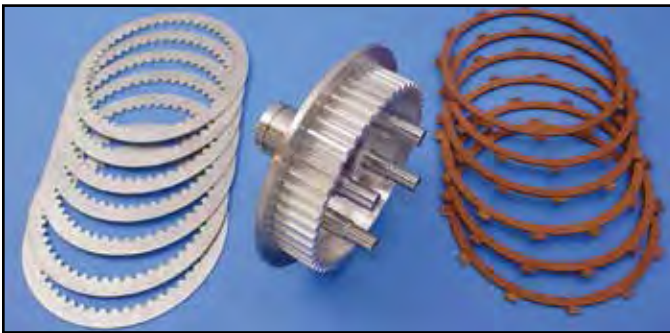

1984-89 Big Twin Clutch Hub Kit includes updated reinforced steel center clutch hub, steel drive plate set and friction plate set.
VT No. 18-0541



1985-90 Clutch Hub Sleeve is a reinforcement ring for hubs at the tapered end. Sleeve is pressed on with beveled side out toward inner primary, after clutch drum with bearing is set over hub, so that clutch drum and hub will be installed as one unit.



VT No.	Type
18-8240	Aluminum one piece type hub
18-8241	Steel two piece type hub

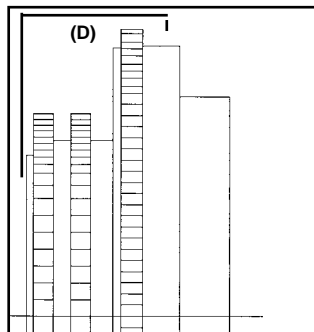

Clutch Drum and Hub Assembly. Bearing and snap ring are installed in drum. Starter ring gear offset dimension shown (D).

VT No.	Year	Starter Ring Offset
18-0186	1984-Early85	1.670
18-0187	Late1985-90	2.087