



Ignition Kit and Advance Unit



Self Learning Module from Accel helps regain control of fuel injected bike. Improves mileage while increasing power and torque, while reducing emissions. It works on all stock and mildly modified. Automatic recalibration-optimizing modifications gains expected from performance exhausts, air cleaners and camshafts. Easy installation-direct plug-in connections to factory throttle position, crank shaft position and oxygen sensors. Self learning-module seamlessly compensates for changing loads, weather conditions and altitude while you ride; no need for costly dyno tuning sessions or downloading new calibration maps to a laptop computer. Smoother running engine-eliminates pop and bang associated with a mis-programmed ECU due to intake or exhaust modifications, the need to re-flash the factory ECU has been eliminated, truly a plug and play proposition.

VT No.	Accel No.	Fits
32-1700	SLM01	95-04 Touring*, 01-04 Softail* 02-04 Dynaglide*, 02-07 V-Rod

Kit includes one O2 sensor and one O2 sensor bung to be welded in.

32-1702	SLM03	08-11 V-Rod
32-1703	SLM04	06-11 Dynaglide 07-11 Softail 07 Touring

Kit utilizes factory installed O2 sensors

32-1704	SLM05	08-09 Touring with "throttle by wire"
---------	-------	---------------------------------------



Accel Late Model Super Coil for late model Twins with carburetor. Features faster rise time, higher voltage, maximum spark and energy to spark plugs for quicker starting, improved idle and crisper throttle response. Fits in OEM loca-

tion and is available in black finish. Fits 2000-02 FXST-FLST, 2000-05 FXD, 2002-06 FLT with carburetor.

VT No. 32-1810



V-Tech Ignition Kits are available in **dual fire** where there are two sparks at the same time and **single fire** where there is one spark for each cylinder when it is fired, separately. Each kit includes a mechanical advance unit and all hardware. Order coil separately VT No. 32-0467 coil has two separate coils inside to fire independently.

VT No.	Type	Coil
32-0468	Dual Fire	32-0511
32-0469	Single Fire	32-0467

Ignition Wire Chrome Clamps.

VT No.	Type
37-9014	Points
37-9015	Electronic



V-Tech™ Single Fire Coil gives one spark for each cylinder as fired and will mount to stock bracket and accept stock coil cover.

VT No.	Finish
32-0467	Black
32-0474	Chrome



Ignition Sensor Plate Assembly.

VT No.	OEM	Fits
32-9020	32400-80A	1980-93 FLT, 1980-94 FXR 1984-95 FXST
32-0518	32404-90	1991-95 FXD
32-0519	32400-94	1994-95 FLT

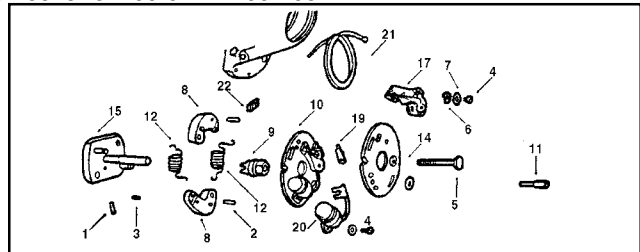

Advance Unit Rebuild Parts.

VT No.	OEM	#	Item
32-7510	32505-78A		Rotor and Weight Assembly
12-1163	615	1	Roll Pin Breaker Plate
12-1164	620	2	Roll Pin Breaker Weight
12-1162	623	3	Roll Pin, Breaker Plate
12-1152	8699		Pop Rivet for Cover
37-8809	1047,7115 6189W	4	Point Mount Plate Washer and Screw Assortment
32-0055	3570	5	Timing Screw
32-0138	32522-70	8	Weight Set
32-0053	32542-70A	9	Cam only
32-0549	32577-70	10	Breaker Base Assembly
32-0051	32601-78	11	Plate Mount Stud 1970-81 Colony, Zinc
2745-2	As Above		
32-0049	32606-82	11	Plate Mount Stud 1982-up
32-0054	As Above	11	Oversize with 12/24 threads for Stripped out Covers
13-0121	32605-70	12	Springs
32-0042	32618-70A	14	Mount Plate only
32-0118	32661-70	17	Ignition Point
32-0411	32670-70	19	Terminal Kit
32-0121	32726-30A	20	Condenser and Bracket
32-1557	70456-73	21	Point Lead Wire
37-8971	10046	22	Point Lead Wire Clamp



Important Note: Some items on this page may be emission-related parts subject to California or other emission control laws. Please see note on page 71 for important information regarding emission control regulatory compliance and warranty information.

