

VT No.	Jims	#	OEM	Type	Year
12-1449			26345-36	Drive Gear	1936-72
12-1220			26325-36	Scavenger Idler	1936-40
12-1221			26315-36	Feed Gear	1936-40
12-0179			26317-36	Feed Idler	1936-40
12-0167			26320-36	Scavenger	1936-40
12-0168			26315-48	Feed	1948-61
	12-1434	A	26315-68A	Return Drive	
12-0166		B	26317-48	Idler Feed	1948-61
12-0170		B	26317-62	Idler Feed	1962-67
12-1420	12-1435	D	26317-68A	Return Idler	
12-0167		C	26320-36	Scavenger Gear	1936-up
12-0169		D	26325-49	Scavenger Idler	1949-62
12-0174		D	26326-62A	Scavenger Idler	1962-up
12-0801			26327-68	Idler Shaft	1968-99
12-0800			26327-52	Idler Shaft	1962-67
12-0802			26328-41	Idler Shaft	1941-66
12-1437		A	26328-74	Feed Drive	
12-9905		E	26237-50	Cover	1948-67
12-0801			26327-68	Idler Shaft	1968-99
12-0805			26346-70	Drive Shaft	1970-99
12-0812			26346-36	Drive Shaft	1936-67
12-0803			26346-36	Drive Shaft	1936-67
12-0804			26346-68	Drive Shaft	1968-69
10-0703			24641-36	Bushing	1936-99
40-0510		F	26424-50	Fitting	1948-67
12-0204			26340-36	Key	1941-67
12-0205			26348-15	Key	1936-67
16-1033				Burnish Tool	All

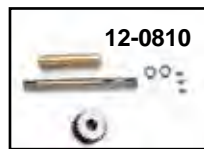

**Sifton Big Twin Oil Pump Drive Shaft Kit** includes 3 keys, shaft gear, bushing and snap ring.

Kit	Shaft	Year
12-0808	12-0812	1936-67
12-0809	12-0804	1968-69
12-0811		1970-72
12-0810	12-0805	1973-99

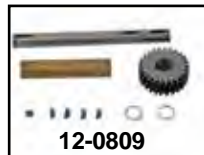

**Oil Pump Mounting Screw** replaces 1397 for use on all 1941-49 Big Twin models.  
VT No. 12-1405

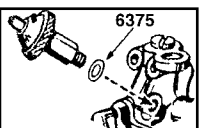

**Sealing Washers** for oil fitting, pressure switch, relief valve, check valve, and tappet oil screen in brass.

VT No.	OEM	Fits	Type
14-0031	6156	1941-69	Big Twin Adjuster Screw
14-0032	6581	1954-78	Big Twin Relief Valve Plug
14-0033	6377	1950-99	Big Twin Oil Pressure
14-0178	6375	1946-57	Big Twin Pressure Switch

# Oil Pump

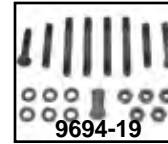
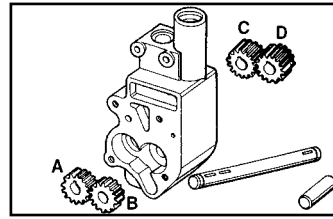

**Replica Oil Pump Mount Kits** for Big Twins includes studs where required. Available as stock style fasteners in chrome, cadmium, parkerized or zinc finish or as custom kits in acorn or allens.

Chrome	Cadmium	Parkerized	Zinc	Acorn	Allen	Years/Style
8740-19	8741-19	9694-19	—	—	—	1936-67 OHV
8742-14	8743-14	—	—	—	8746-12	1968-77 Stock
8744-12	—	—	9787-12	7827-12	8747-12	1978-91 Stock



**S&S Oil Pump Gasket and Master Rebuild Kits** are available with paper or mylar gaskets. Gasket kits include inner and outer gaskets, drive shaft key and snap ring. Master rebuild kits include seal, snap rings, springs, ball, inner and outer gasket, O-rings, and keys.

Gasket Kit	Master Rebuild Kit	Type	Year
15-0657	—	Mylar	1936-91
15-0658	15-0361	Paper	1936-91
15-0362	15-0364	Mylar	1992-99
15-0363	—	Paper	1992-99

**A-Long Oil Pump Nut** with 1/4-24 thread. Used on 1936-67 OHV. Sold each.

VT No.	Finish
8108-1	Chrome
8109-1	Cadmium
9674-1	Parkerized



**B-Standard 1/4 - 24 Thread Hex Nut**, 12 pieces.

8110-12	Chrome
8111-12	Cadmium
9673-12	Parkerized

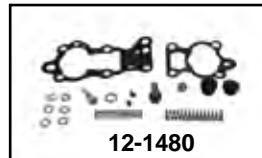

**Oil Pump Gasket Kits** include gaskets, seals, snap ring, balls and keys. Spring and ball bearing not included with James kits.

James	GB No.	Type	Year/Model
—	12-1480	Paper	1936-40 Over Head Valve
15-1184	14-0008	Paper	1941-49 Big Twin
15-0851	14-0009	Paper	1948-67 Big Twin
15-0852	15-0193	Mylar	1968-80 Big Twin
15-0853	14-0025	Paper	1968-80 Big Twin
15-0854	15-0233	Mylar	1981-91
15-0855	14-0026	Paper	1981-91

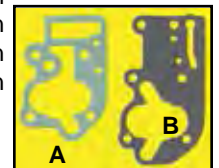

**Big Twin Oil Pump Gaskets** are available in 10 pack.

James	GB No.	#	OEM	Use	Years
15-0939	15-0127	B	26246-68A	Case	1968-80
—	15-0455		26246-68A	Case	1968-80
15-0952	15-0137	B	26273-80B	Case	1980-91
—	15-0727		26245-41	Case	1941-67 (Mylar)
15-0126	—		26245-41	Case	1941-67 (Mylar)
15-0949	15-0293	A	26258-68B	Cover	1968-80
15-0940	15-0294	B	26246-68A	Case	1968-80
15-0953	15-0295	B	26273-80B	Case	1980-91
15-0956	15-0296	A	26276-80A	Cover	1980-91