

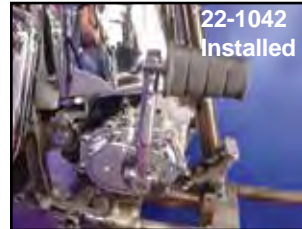

# 4-Speed Kick Starter Kit



**Heavy Duty Kick Start Kit** features a chrome smooth thick wall kick cover and heavy duty kick starter arm. Fits all 4-Speed Big Twin 1936-84. Requires use of wafer type release bearing kit.

VT No.	Item	Year
22-1020	Kick Starter Kit	1936-84
22-0834	Kick Starter Kit	1941-84
18-3203	Release Kit	1936-64
18-3204	Release Kit	1965-69
18-3607	Release Kit	1970-84



**V-Twin Complete Kick Starter Kit** fits 1936-84 models. Kit includes a reinforced kick cover, chrome arm and all gears and hardware to make conversion complete. Kit available with a polished or chrome plated kick starter cover.

VT No.	Type
22-0301	Chrome
22-0302	Polished

\*Note: When Installing any type of our 74-80 kick starter kits on 1980-85 4-Speed, our VT No. 17-0101 late bearing retainer, which incorporates a kick starter stop built in is required.

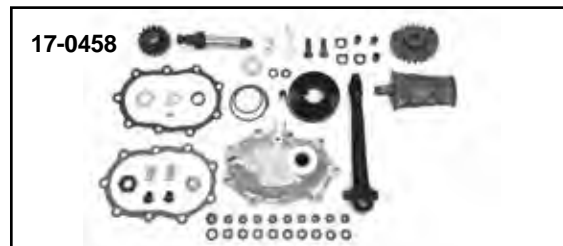

**Kick Starter Kit** fits 1936-84 4 Speed Big Twin. Kit includes cast cover, black arm and parkerized nut set as shown and comes partially assembled with finger shaft and clutch release finger. Kit also includes gasket and chrome hex nuts.

VT No.	Year	Type
22-1042	1941-64	Chrome
22-1124	1941-64	Replica
22-1047	1936-84	Replica
22-0212	1941-64	Replica
22-1157	1941-52	Replica
17-0458	1954-63	Replica

**Our Original Kick Starter Kit Developed in 1979!**