



# 41mm 10" Dual Disc Fork Assembly



**Glide Fork Assembly** with chrome sliders accepts left side drum brake. Assembly features black triple trees without lock tab and 3" center to center spacing which will accept rubber bushing kit.  
**VT No. 24-0867**



**49mm Fork Assembly** includes chrome upper and lower trees with stock tubes and chrome sliders. Fits 1971-99 FX.  
**VT No. 24-1319**



**Dual Disc Fork Assembly** uses two 11" rotors for FL-FX 1971-84.  
**VT No. 24-0086**



**41mm Glide Fork Assemblies** include forged chrome replica triple trees and hard chrome tubes on stock length forks, chrome tubes on overstock length and polished or chrome lower legs with all internals installed less hardware. Stock overall length is 31".

**FXWG Style Dual Disc Fork/Wheel and Caliper Assemblies** to fit 1948-99 Big Twin FL-FX-FXWG feature polished or chromed lower sliders without reflector boss, hard chrome fork tubes and internals installed. Includes chrome trees with 1" diameter stem and frame lock tab, neck bearings, axle spacer and top nut. Stock length is 31" overall. Kit also includes 21" all chrome assembled wheel with bearings, drilled 10" steel brake discs with chrome screws, and choice of black or chrome dual disc calipers complete with pads. VT No. 24-9947 has smooth lower legs.

VT No.	Item	Caliper	Sliders
24-2000	Kit	Chrome	Polished
24-2011	Kit	Chrome	Chrome

VT No.	Item	Sliders
24-0779	Fork Assembly	Polished
24-9974	Fork Assembly	Chrome
24-9947	Fork Assembly	Polished

**Fork Installation Kit** fits 1973-84 FL, 1980-83 FXWG.  
**VT No. 24-0776**

The V-Twin™ Fork Assembly is shipped complete with axle, axle nut, spacer, top nut, bearings, cone nut, dust cover, triple trees, fork tubes and sliders. Fork tubes and sliders are fully assembled with internals. Final assembly of the remaining components is done by the dealer. Every leg assembly is shipped dry. We recommend use of the appropriate fork oil such as Type B. The amount of fork oil to add varies by model. A FX will need about 6 oz per leg, a FL will need about 8.5 oz per leg and a FXWG needs about 10 oz per leg. Due to oil cling, a dry fork leg needs about 1 oz more to fill than a drained leg would require.

## Bare Fork Assembly



**FXWG Dual Disc Fork Assembly Front Wheel Speedometer Drive Kit** will allow use of 2:1 ratio speedometer. Kit includes axle, speedometer drive and adapter flange.  
**VT No. 36-0547**



**Fork Installation Kit** includes two bearings, dust covers, top nut axle and related hardware. Fits 1980-83 FXWG with dual disc.  
**VT No. 24-0776**

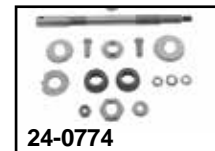

**Bare Fork Assembly** includes stock leg assembly with hard chrome tubes on stock length forks and chrome tubes on overstock length and polished or chrome lower legs with all internals installed, with chrome triple tree set, less hardware. Stock overall length is 31".

**Fork Installation Kit** includes two bearings, dust covers, top nut, axle and related hardware.

	(A) FXWG, Dual 10"		(B) FXST, Single 11.5"		(C) FXST, Dual, 11.5"	
	Polish	Chrome	Polish	Chrome	Polish	Chrome
Stock	24-1500	24-1525	—	24-1532	24-1501	24-1546
2"	24-1503	24-1526	24-1509	24-1533	24-1515	24-1540
4"	24-1504	24-1527	24-1510	24-1534	24-1516	24-1541
6"	24-1505	24-1528	24-1511	24-1535	24-1517	24-1542
8"	—	—	24-1512	24-1537	24-1518	24-1543
10"	—	—	24-1513	24-1538	24-1519	24-1544
12"	—	—	24-1514	24-1539	24-1520	24-1545

VT No.	Type	Year	Model
24-0776	2 Disc	1980-83	FXWG
24-0774	1 Disc	1984-99	FXST
24-0833	1 Disc	1986-99	FLST
24-0772	2 Disc	1984-99	FLT
24-1158	2 Disc	2000-07	FLT
24-0773	2 Disc	1986-99	FLST