

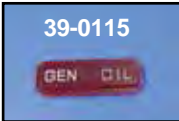

Dash Kit

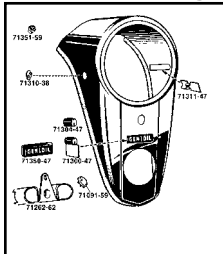

V-Twin Original Dash Kits First Offered in 1984!



Steel Dash Panel Components

VT No.	OEM	Item	Light
39-0349	71300-47	Lens Holder	2
39-0115	71350-47	Lens	2
39-0354	71310-38	Cover Plug, 1939-67	All
39-0353	71311-47	Cover Side Plate	2
39-0344	71292 62	Shield	3
39-0114	71091-59	Lens Set	3
	71351-59	2 Red, 1 Blue	3



Two and Three Light Dash Panels. Two light fits 1947-61 Big Twin and 45 models. Three light type fits 1962-67 Big Twin.

VT No.	Item	Item	Finish
39-0111	2-Light Dash	Dash	Chrome
39-0953	2-Light Dash	Dash	Raw
39-0952	3-Light Dash	Dash	Raw
39-0110	3-Light Dash	Dash	Chrome
28-0542	Strip		Rubber
39-0144	Without key switch hole		Chrome
39-0459	Rail Kit	Deco	Chrome

Two or Three Light Dash Kit is complete as illustrated. Includes either 1:1 or 2:1 ratio speedometer and the correct five post key switch with two keys. Order Plainbase dash kit when it is not desired to rewire harness for dash lighting. Choose proper cable for each application. Nothing else to buy! 3 light dash kit pictured. Can be mounted on 1947-84 FL Big Twin models.

VT No.	Type
39-0904	3 Light Plain Base 1:1
39-0951	3 Light Plain Base without Speedometer
39-0905	2 Light Plain Base 1:1
39-0906	3 Light Plain Base 2:1
39-0907	2 Light Plain Base 2:1
39-0908	3 Light Wired Base 1:1
39-0909	2 Light Wired Base 1:1
39-0910	3 Light Wired Base 2:1
39-0911	2 Light Wired Base 2:1
33-0534	Bulb Socket, pair



V-Twin Dash Kits are available with the popular tachometer-speedometer combination included. Can be wired to 1978-up FX-FL models with a tach that is triggered by coil impulse. See instructions for tach wiring. Wired base includes light sockets and all hardware for installation.

VT No.	Type	Ratio
39-0915	2 lite	2:1
39-0916	3 lite	2:1
39-0917	2 lite	1:1
39-0918	3 lite	1:1



Dash Panel Mounting Stud and Center Screw features chrome domed center screw, stud and lock nuts to mount two light steel dashes to 1947-67.

VT No.	Item
7716-2	Kit, Colony
39-0123	Kit, V-Twin
39-0226	Center Stud
8483-2	Center Screw only
39-0155	Lock Tab only



Chrome Dash with 91.5 mm speedometer hole accepts electronic speedometer from XL-FXD models.

VT No.	Type
39-0892	Smooth
39-0893	3-Light

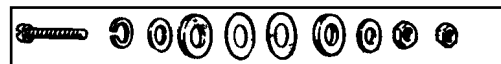

Dash Insulator and Bolt Hardware Kit is sold in three pack, for dash rebuilding.

VT No. 32-8013

