



Rocker Arm



11-9511



11-9512

Rocker Arms include bushings installed.

VT No.	OEM	Type	Brand
1986-up Evolution			
11-9511	17360-83	As Above.	Sifton
11-9512	17375-83	As Above	Sifton
1957-85			
11-0522	17394-57A	F. Ex	VT
11-0523	17395-57A	R. Ex	VT
11-0524	17396-57A	F. In	VT
11-0525	17397-57A	R. In	VT
11-1066	Set with shafts		VT



Rocker Arm Shaft.

VT No.	OEM	U/M	Brand
Fits 1957-85			
11-0518	17435-57A	Each	Sifton
11-1068	17435-57A	Set	Sifton
11-0541	As Above	Each	Jims
Fits 1986-up			
11-0571	17611-83	Set of 4	Sifton
11-0576	17611-83	Set of 4	Jims
11-0814	17611-83	Each	
		.005 Oversize	Sifton



Rocker Arm and Shaft Kit by Sifton fits 1986-up models. Includes (2) 17375-83 rocker arm, (2) 17360-83 rocker arm and (4) 17611-83 shafts. **VT No. 11-0572**



Rocker Box available with polished or chrome finish for Iron Head Sportster. Fits 1957-85 XL.

VT No.	Finish	Note
11-0677	Chrome Set	Bare
11-0855	Polish Set	Bare
11-0078	Chrome Set	Assembled
11-0867	Polished Set	Assembled



Sifon Rocker Arm Seals are machined of nylon to replace rubber O-rings on 1957-85 models. **VT No. 14-0148**

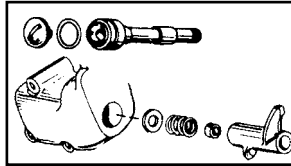

Rocker Arm Spacer and Shims.

VT No.	OEM	Item	Qty
12-2116	17451-57	Spacer	10 pack
13-0100	17483-57	Springs	10 pack
14-0501	11101	O-Ring	10 pack



14-0501



Rocker Arm Shims fit 1957-85.

VT No.	Size
12-0704	.005
12-0710	.007
12-0715	.015



Rocker Arm Bushings replace 17428-57. Use on 1957-up models. Eight pieces.

VT No.	Type
10-0700	Stock Split type
10-2106	As Above, Sifton



Sifton Rocker Arm and Shaft Kit fits 1957-84 XL Iron Head models and includes four rocker arms with bushings installed, four shafts, shims, spacers, chrome replica end caps and nuts.

VT No. 11-0820



7142-4

Chrome Rocker Shaft End Plugs.

Installation or removal is much easier than original slotted part. Packaged four per set.

VT No.	Fits
7142-4	1971-84
7143-4	1957-70



8224-8

Rocker Shaft End Cap Kit for Sportster as replica type with hex caps for left side.

VT No.	Year	Finish	Nut Type
2019-8*	1957-84	Chrome	Slot
2020-8*	1957-84	Cadmium	Slot
8222-8	1957-70	Chrome	Slot
8223-8	1957-70	Cadmium	Slot
8224-8	1971-84	Chrome	Allen
8225-8	1971-84	Cadmium	Allen

*Note: Feature 1/2 x 20 thread to be used on later type rocker shafts.



Chrome Allen Rocker Shaft Plugs.

Set of 4. Fit 1971-84 XL models. Includes sockets and cups.

VT No. 37-0025



Rocker Box Bolts for both heads, includes washers.

Available in stock hex type, acorn or allen.

Colony	VT No.	Year	Finish	Type
	9829-28	—	1957-76 Chrome	Hex
	9830-28	—	1957-76 Cadmium	Hex
	7136-14	—	1957-76 Chrome	Acorn
	8789-28	—	1957-76 Chrome	Allen
	9831-28	37-9395	1977-85 Chrome	Hex
	9831-28T		1977-85 Chrome	Hex
	9832-28	—	1977-85 Cadmium	Hex
	8790-28	—	1977-85 Chrome	Allen



8400-8



8730-8

Rocker Shaft End Nut Kit includes four acorn or cap style nuts and washers for replacing

VT No.	#	Type	Finish
8400-8	A	Cap	Chrome
8401-8	A	Cap	Cadmium
8730-8	B	Acorn	Chrome
12-1193	B	Washers	Zinc



Chrome Rocker Shaft End Caps provide ease of installation with ample clearance between gas tank.

VT No. 8614-4