



Tail Lamp



33-2160



33-2152

Bobber Tail Lamp is a replica version of late 1940's black tail lamp with chrome bullet hood and glass lens. Mounts to fender and includes license mount plate slots.

VT No. Finish

33-2160 Chrome

33-2152 Black

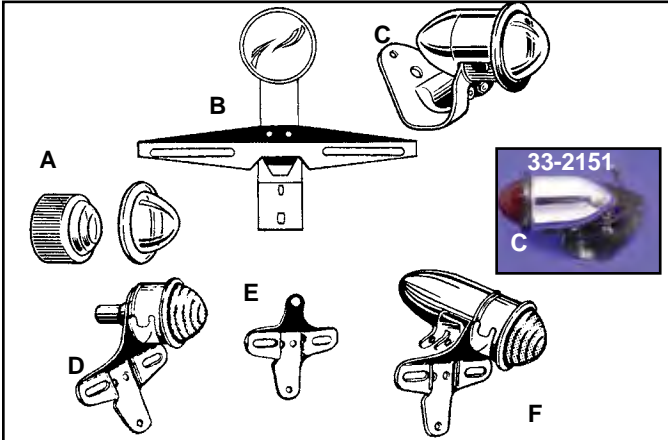

Early Tail Lamps and Parts. All complete lamps include glass lenses and bulb socket. **Note:** Lenses are in glass.

VT No.	#	OEM	Year
33-1521	A	—	1924-27
33-2154	A	68092-25	1935-38
		68091-20	Lens Set
15-0582			1925-38 Gasket Set, Round Style
15-0719		68126-36	Gasket
15-0718		68125-25	Gasket
33-2147		68105-20	Lens Ring
33-2150	B		Complete 1915-33, dual
33-3034			Tail Lamp Complete, faceted
33-2151	C		K Tail Lamp 1952-54 Kit with Chrome Hood
31-0237		59991-52	1952-54 K License Plate Bracket
33-2174	D		Complete 1934-38 Complete VL, Single
33-2152	D		Complete 1934-38 Complete VL, Dual
33-2177	D		Complete As Above with Chrome Cup
49-2545	E		1934-38 Bracket Only
33-2160	F		Complete 1947-55 Hummer with Chrome Hood
33-0972			Clear Cup Lens
33-1951			Morse Nut



Bracket for vintage sconce tail lamp assembly. Fits 1999-up FXD and XL.

VT No. 31-0594

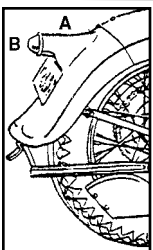

49-2589
Installed



49-2589

1934-38 Tail Lamp & Shroud. Shroud must be welded to fender, tail lamp bolts on underneath. Order separately.

VT No. # Item

49-2589 A Shroud

33-2152 B Complete Tail Lamp



33-0304



33-0740



33-0735



31-9998

Beehive Tail Lamp bracket included as on 1939-46 models, for decorative use only, not D.O.T. approved. 33-0740 steel lamp has a glass lens, but does not include a 31-9998 bracket.

VT No.	Item	Type	Lens
33-0304	Complete	Chrome	Plastic
33-0980	Complete	Chrome	Glass
33-0950	Replica	Chrome	Plastic
33-0735	Replica	Black	Plastic
33-0740*	Replica	Black	Glass

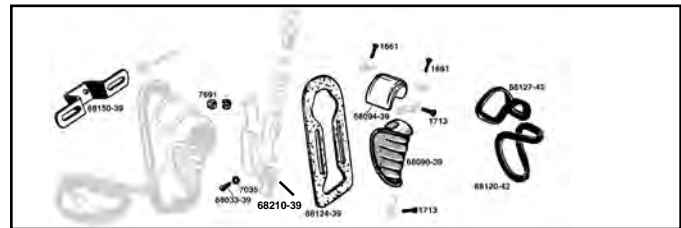

33-1336



Parts for 1939-48 Beehive Tail Lamp available separately.

VT No.	OEM	Item	Type
33-1987	68094-39	Top Lens	Plastic
33-1988	68090-39	Red Lens	Plastic
33-2051	68094-39	Top Lens	Glass
33-2052	68090-39	Red Lens	Glass
15-0667	68127-42	Top Lens	Gasket
15-1330	68120-42	Red Lens	Gasket
31-0401	68150-39	Bracket	Chrome
31-9998	68150-39	Bracket	Parkerized
9813-12	68033-39	Mount Bolt Kit	Parkerized
15-0325	5056-39	Mount Gasket	Paper
15-0291	5056-39	Mount Gasket	Rubber
32-0959		Cloth Wire	Assembly
32-9307		Cloth Wire	Assembly
33-1336		Kit	Lens
33-2256	68210-39	Lamp Base	

Beehive Tail Lamp Mounting Kit for 1936-46. Screws also fit 1936-38 dash cover.
VT No. 9813-12

Lamps listed are for show or decorative use only, not D.O.T. approved.