



Signal Mount



Chrome Turn Signal Bracket Set fits 1997-13 Road King Nacelle models. Mount holes are 6 $\frac{3}{4}$ ".
VT No. 31-0964



Chrome Turn Signal Swivel Mount Assembly for 1988-up FXST and 1991-up FXD models.
VT No. 31-0582

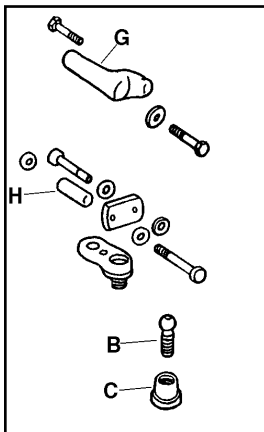

1988-up Front Signal Mount Parts for Sportster models.

- | VT No. | # | Item |
|---------|---|-------------------------|
| 31-4067 | B | Ball Stud, 2 pack |
| 31-0582 | C | Clamp, Ball Stud 2 pack |
| 31-4072 | G | Support, Front, each |
| 31-4073 | H | Spacer, Front 2 pack |



Chrome Short Rear Turn Signal Mounts move turn signals in 1 $\frac{1}{2}$ " on each side for 1984-98 FXST, 1973-85 FX models, pair.
VT No. 31-0554



31-9913



31-9986



31-9925

Directional Signal Relocation Kits includes special hardware and extension for models listed to provide clearance for saddlebags.

VT No.	Fits	Model
31-9913	1979-89	FXR
31-9986	1986-up	FXST
31-9925	1994-03	XL



31-0181



31-0255



31-0163



31-0161



31-0162



31-9979



31-9962

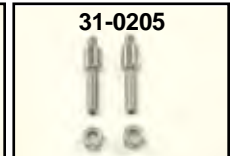

31-0205

Turn Signal Mounting Hardware fits models from 1973 to present.

- | VT No. | Item |
|---------|---|
| 31-0181 | Bracket fits between turn sign lamp and handlebar clamp |
| 31-0255 | Clamp screw, 2 short, 2 long, four pieces |
| 31-0163 | Stud kit with spacer |
| 31-0161 | Rear support with screw |
| 31-0479 | 1993-up Bracket with screw, pair |
| 31-0162 | Clamp Set, 1973-81 |
| 31-9980 | Clamp Set, 1982-up |
| 31-9979 | Rear Turn Signal Stud, each |
| 31-9962 | Rear Turn Signal Stud; $\frac{1}{2}$ " shorter |
| 31-0205 | Rear Turn Signal Stud; $\frac{3}{8}$ " long |
| 37-0574 | Spacer |



31-0327



31-0328



37-9095

- | VT No. | Fits |
|---------|------------------|
| 31-0327 | FXSTD, Rear |
| 31-0328 | Softtail, Rear |
| 37-9095 | XL Rear Extended |



Front Turn Signal Relocation Kits fits 1996-up FLT.

- | VT No. | Fits |
|---------|-----------------------|
| 31-0353 | With Spot Lamp Bar |
| 31-0354 | Without Spot Lamp Bar |