



Seat Post



Heavy Duty Seat Post Spring Set includes full set of springs and spacers.
VT No. 13-9253 Kit
49-0263 Spacer Set



Seat Post Bushings. Bronze.

VT No. Years Model
8859-1 1929-73 45
7708-1 1936-57 Big Twin
7708-1T 1936-57 Big Twin
10-1288 1936-57 Big Twin
10-2497 1958-79 Big Twin
2084-2 1958-79 Big Twin



Seat Post Bushing Installation Tools.
2086-1 1936-57 Big Twin
2085-2 1958-79 Big Twin



Seat Clevis Pin and Spring is a reproduction of seat pin and spring retainer used on all models with seat post 1929-up.

VT No. Item
8623-2 Kit
8623-2T Kit, V-Twin
2731-2 Pin



Seat Post Rod Lock Nut and Lockwasher fits all models 1925-81 except FX, FL. Replaces 51674-25.



VT No. Finish
8874-2 Cadmium
8874-2T Zinc
9691-2 Parkerized

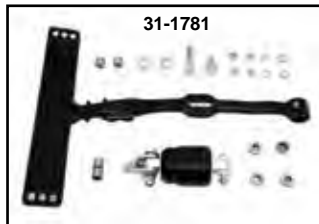

Seat T and Shock Piston Set.

VT No. Finish
31-0965 Chrome
31-1781 Black



Mini-Shock will replace Big Twin seat post in 1936-80 frames includes adapter clevis to connect to tee.



VT No. Item
54-0650 Mini-Shock
54-0955 Mini-Shock 4"
54-0407 Clevis

Note: Seat "Tee" Components are compatible with the seat spring posts as fitted to 1930-80 models of Big Twins and 45 models. Big Twins 1930-80 are machined to fit a seat post bushing and seat post.

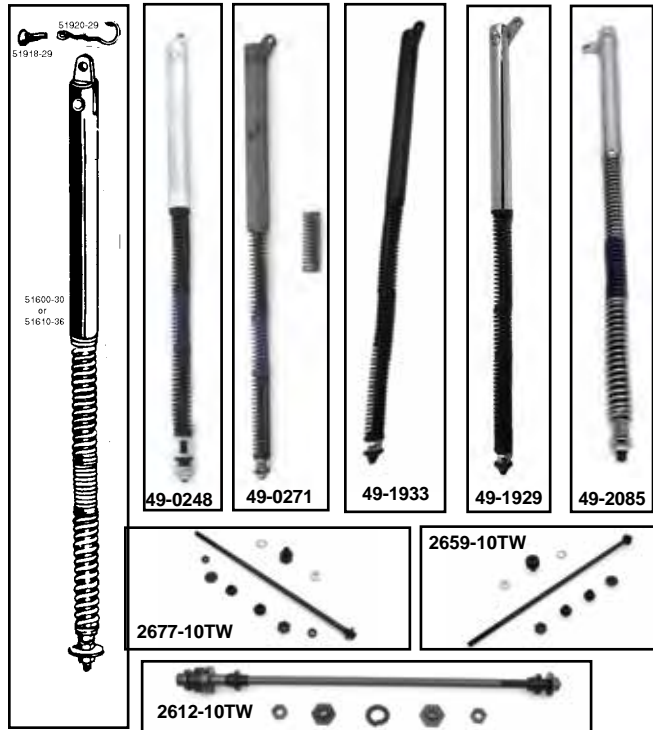

Seat Posts for 74, 80 and 45 models are assembled with springs and hardware. Top clevis pin and bottom nut are sold separately.

Note: 49-1933 post is diameter 1.060", 49-0181 and 49-1929 posts are 1.180" diameter

VT No.	OEM	Fits	Finish
45 Solo & Servi-Car			
49-1933	51602-30	1930-73 45's	Black
49-1926	Heavy	1930-73 45's	Black
49-2019	Heavy	1930-73 45's	Chrome
Big Twin			
49-1929	51610-58	1936-80 Big Twin	Chrome
49-0181	51610-58	1936-80 Big Twin	Black
49-0271	—	1936-80 Big Twin	Heavy
49-2085	—	1936-80 Big Twin	Heavy, diameter 1.180"
49-0247	—	1936-64 Big Twin	Cadmium
49-0248	—	1936-64 Big Twin	Cadmium (Heavy Duty)
13-0214	Set	1936-80 Spring Set (6 piece)	Complete

Replacement Parts

49-1560	Rebuild Kit
49-0293	Post Top, Big Twin
13-0202	51777-36 Recoil Spring Set Only
13-0212	51770-29 Big Twin and 45 Spring Lower Set, Stock
49-1934	51661-36 Big Twin Seat Post Inner Rod with Spacer
8623-2	51918-29 Top Clevis Pin, Parkerized and Spring Kit
49-0242	As Above Zinc
49-0226	51791-31 Spring Spacer

Rod Kit

Colony	VT No	Size	Fits
2659-10	2659-10TW	15 ⁷ / ₈ "	1929-73 G, 1929-52 W
2677-10	2677-10TW	16 ⁷ / ₈ "	1941-80 FL, 1936-40 EL, 1937-48 UL
2612-10	2612-10TW	15 ⁷ / ₈ "	1941-80 FL, 1936-40 EL, 1937-48 UL