



Wiring Tools



16-1258
Pin and Receptacle Extractor for Molex style connectors.

VT No.	Type
16-1258	Pin
16-1259	Receptacle

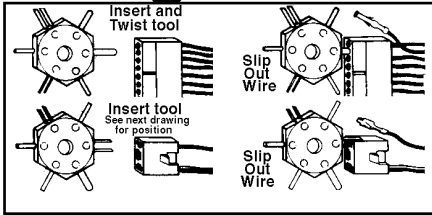

Wire Terminal Tool replaces 97362-71, depresses terminal lock tabs in disassembly of factory wiring harness.
VT No. 16-0959



Spark Plug Wire Tool strips 7 and 8 mm ignition wire, crimps spark plug and distributor terminals.
VT No. 16-0514



Jims Ignition Switch and Fork Lock Tool used to make installing or removing the ignition switch and fork lock a easy process.
VT No. 16-1179

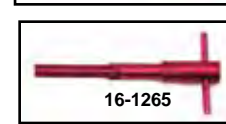

Ignition Switch Housing Tool will align the ignition switch housing as the retaining screws are being torqued. Use for proper alignment of switch knob with housing. Use on all 2003-13 FLT models and 2002-up V-Rods.

VT No.	Year	Type
16-0318	2003-13	Jims
16-0319	2003-up	Jims
16-0017	2003-13	VT
16-0003	2003-13	VT
16-1137	2014-up	Jims
16-1265	2014-up	VT



Wire Terminal Tool crimps factory style wire end.
VT No. 16-0710



Removal Tool Set for Deutsch HD10, HD20, HD30 Connectors.
VT No. 16-0090



Deutsch Terminal Crimping Tool is designed to correctly crimp Deutsch Connectors. Replaces 39965.
VT No. 16-1295

Deutsch Pin Tools.

VT No.	Size	Color
16-0087	20	Red
16-0088	16	Blue
16-0089	14	Green

Deutsch Tools



VO Scope Tool allow the technician the ability to inside mot any hole that is larger than a 1/4". This is a live remote video with the following features high resolution, auto focus, color camera and 2 1/2" full color viewing monitor. Equipped

with a sealed, fluid proof, flexible 24" long 6mm diameter cable, high output LED illumination with dimming control. A mirror used to see 90 degrees and a magnet for picking up steel parts weighing less than 1/4 lb. Used for checking inside cylinders, cylinder heads, etc.

VT No 16-0385



Deutsch Terminal Tool use with stamped type terminals
VT No. 16-0476

Deutsch Terminal Tool use with solid type terminals
VT No. 16-0475



Wire Removal Terminal Tools.

VT No.	Style
16-1618	Mate-N-Lock
16-1619	Molex MX-150
16-0478	Delphi-Packard Weather Pack



Computer Diagnostic Service Tool. This tool is capable of diagnosing trouble codes for all 1994-99 computer controlled Big Twins. Available as a standard tool that includes scan tool, software cables, adapters, A/C power adapter and instruction manual. For USA 110v 60 cycles application.

VT No.	Item
16-5000	Scan tool
16-5002	Delphi System Cartridge 2001-2002 FXST



Daytona Twin Tec Twin Scan II for all 2001-up fuel injected models using Delphi system and 2003-06 carbureted models with 12 pin ignition modules reads and cleans diagnostic trouble codes from engine control unit, turn signal/security module, speedometer and tachometer. The Twin Scan II is especially useful for diagnosing hard to find intermittent trouble codes. The motorcycle can be operated while the unit is installed under normal condition (no trouble codes) the unit will store data of the last hour of operation. If a trouble code is set the unit automatically stop logging data 30 minutes after the code is set. This allows you examine data before and after the code was set. The Twin Scan II interfaces to a laptop PC minimum PC requirement is 300MHz Pentium running Windows 98/ME/XP with SVGA display and available USB port. Also available Twin Cam II and Tuning aid for Screamin' Eagle Race tuner includes all feature of Scan II but allows the tuner to analyze logged data and display front and rear cylinder air/fuel ratio and the required volumetric efficiency correction (in percent) with the same RPM rows and throttle position sensor columns used in the SERT tables. Twin Scan II+ includes WEGO IID dual channel wide ban exhaust gas oxygen sensor interface for logging AFR date along with engine date.

VT No.	Item	Fits
16-0376	Twin Scan 2	2001-12 with J1850 bus
16-0378*	Twin Scan II Plus	As Above
16-0379	Twin Scan 3	2011-u with CAN data bus

*Note: Same features as Twin Scan II with the addition of extended data logging time, USB interface and waterproof construction.